

# Steam Table



## Models

- NST-2-30
- NST-3-44
- NST-4-58
- NST-5-72
- NST-6-86

## Options

- Insert pans and covers
- Single roll cover
- Double roll cover
- Single over shelf
- Double over shelf
- Adapter plates
- Set of four 5" dia. casters (2 swivel, 2 with stops)

## Specifications

- Top and water tank constructed out of heavy-duty 18 gauge construction features an open storage
- Cabinet constructed features an open storage base with an enamel finish (stainless steel optional)
- Standard white cutting board - 3/4" thick
- Standard water fill assembly, including a drain and overflow pipe

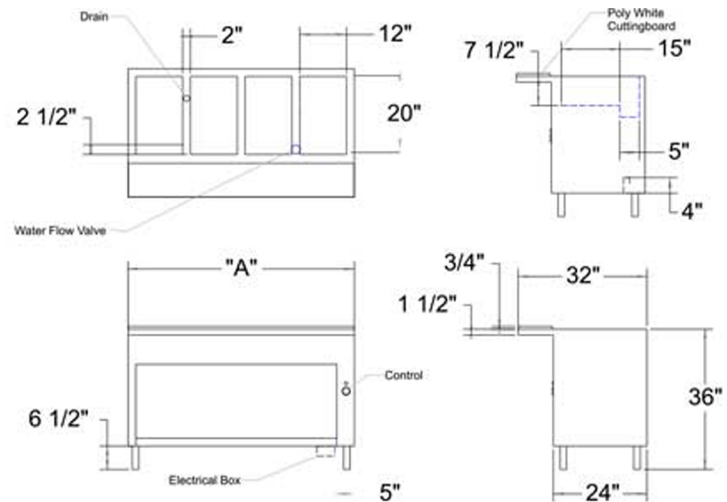

## Dimensions

- For stainless steel body add suffix "S"

### Model

### Wells

### Overall Dimensions

NST-2-30	2	30" x 32" x 36"
NST-3-44	3	33" x 32" x 36"
NST-4-58	4	58" x 32" x 36"
NST-5-72	5	72" x 32" x 36"
NST-6-86	6	86" x 32" x 36"